

MECHANICAL:

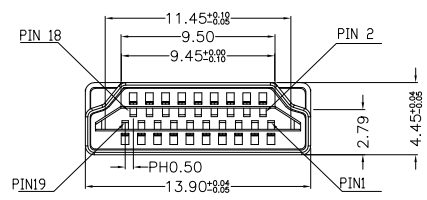

NOTES:

- 1.ELECTRONIC:
CONTACT RESISTANCE: 20mohm MAX
INSULATION RESISTANCE: 1000 Mohm MIN
WITHSTAND VOLTAGE:AC 500V,1min.
- 2.MECHANICAL:
DURABILITY: 10000 CYCLE.
- 3.ENVIRONMENT CHARACTERISTICS:
OPERATING TEMPERATURE:-55°C TO +105°C
- 4.RECOMMANDER PCB THICKNESS 1.2 TO 1.60MM
- 5.PART NO:

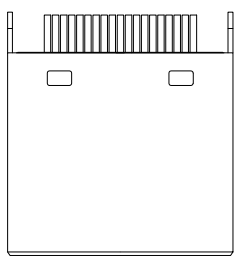
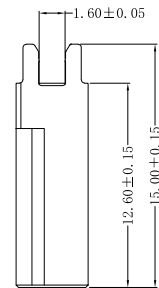
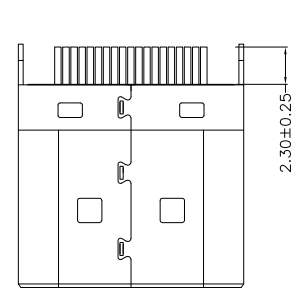
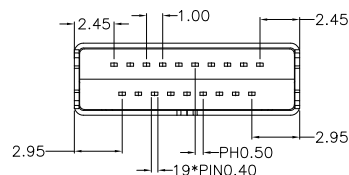
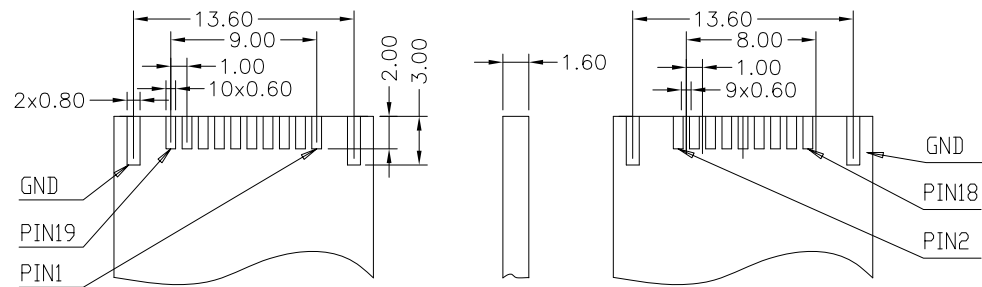

RECOMMENDED PCB LAYOUT2 T=1.60
GENERAL TOLERANCES:±0.05



Champyang International Ltd., Co

AO	RELEASED	Allen	2022-03-09
REV	DESCRIPTION.	APPD.	Date

FILE NO: AHD12 (Series)		TITLE 圖名		HDIM AM For PCB (T=1.6mm) 夾板式		UNIT 單位	mm inch
TOLERANCE(公差): 0.000 mm ± 0.075 mm 0.00 mm ± 0.15 mm 0.0 mm ± 0.25 mm		PART NO. 料號		AHD12-34F-CR-A		SCALE 比例	1:1
		DRAWN BY 製圖	Ray	DATE 日期	2022-03-09	REV. 版本	A0
		CHECKED BY 審核	Allen	DATE 日期	2022-03-09		