

MECHANICAL:

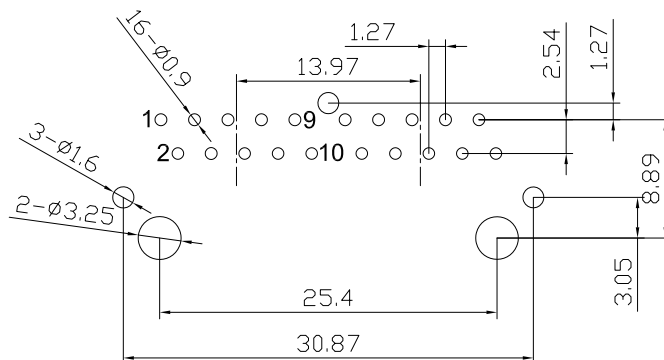
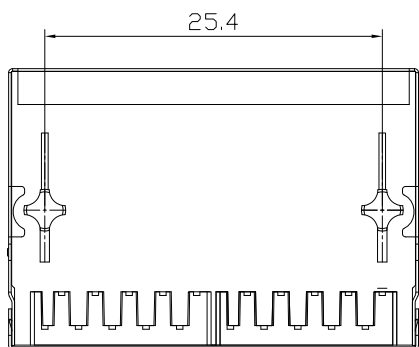
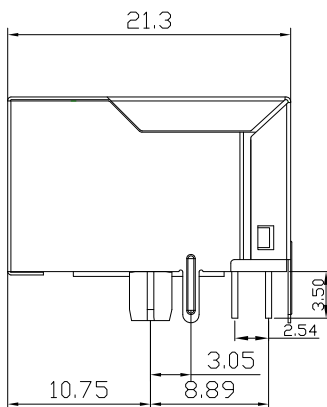
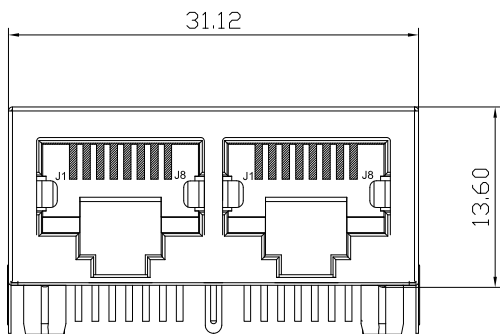

PC Board Layout
Component Side Shown

Note:

Metal Shell :Copper Alloy, Finish: 30u" Nickel
 Housing :Thermoplastic,PA66 BLACK,UL 94V-0,ROHS
 Insert :Thermoplastic,PA46,UL 94V-0,Black
 Contact Terminal/phosphor Bronze
 6u" Gold on Contact Area. 100u" Tin on Solder,
 Both over 50u" Nickel Under-Plated

Meets or exceeds IEEE 802.3 standard for 10/100/1000 Base-TX
 350uH minimum OCL with 8mA Bias current
 Available with or without LEDs
 Minimum 1500Vrms isolation per IEEE802.3 requirement
 Operating temperature 0°C to +70°C
 Storage temperature -40°C to +85°C



Champyang International Ltd., Co

A0	RELEASED	Allen	2022-03-29
REV	DESCRIPTION.	APPD.	Date

FILE NO : ARJ10(Series)		TITLE 圖名		RJ45 Connector With Transformer 1000Base Tab-down 1x2 Port		UNIT 單位	mm inch
TOLERANCE(公差): 0.000 mm ± 0.075 mm 0.00 mm ± 0.15 mm 0.0 mm ± 0.25 mm		PART NO. 料號		ARJ10-020810-311-SOT21-A		SCALE 比例	1:1
		DRAWN BY 製圖		Ray	DATE 日期	2022-03-29	REV. 版本
		CHECKED BY 審核		Allen	DATE 日期	2022-03-29	

ELECTRICAL SPECIFICATIONS@25°C UNLESS OTHERWISE NOTED:

- 1.Turn Ratio(+/-2%):1CT:1CT
- 2.Inductance OCL:
350uH Min @100KHz 0.1V DC BIAS 8mA
- 3.Insertion Loss:
-1.0dB Max @1.0-100MHz
- 4.Return Loss:
-20dB Min @1-10MHz
-16dB Min @10-30MHz
-12dB Min @30-60MHz
-10dB Min @60-100MHz
- 5.Cross talk:
-40dB Min @1-30MHz
-35dB Min @30-60MHz
-30dB Min @60-100MHz
- 6.Common Mode Rejection:
-35dB Min @1-100MHz
-20dB Min @50-150MHz
- 7.HIPOT TEST:1500Vrms 1mA.Max

SCHEMATICS :

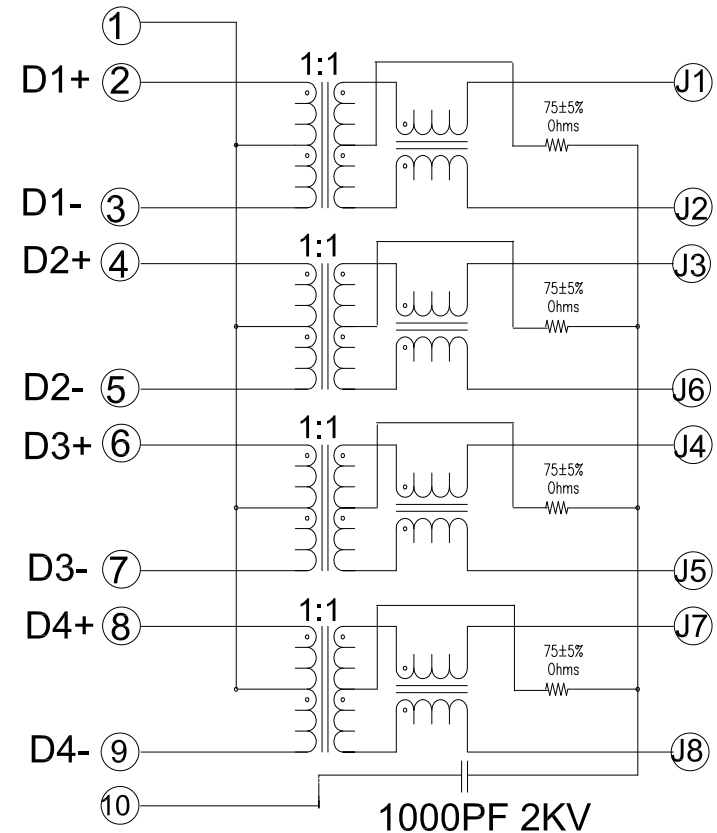

Champyang International Ltd., Co

A0	RELEASED	Allen	2022-03-29
REV	DESCRIPTION.	APPD.	Date

FILE NO : ARJ10 (Series)		TITLE 圖名		Transformer 1000 Base		UNIT 單位	mm inch
TOLERANCE(公差): 0.000 mm ± 0.075 mm 0.00 mm ± 0.15 mm 0.0 mm ± 0.25 mm		PART NO. 料號		ARJ10-T21		SCALE 比例	1 : 1
DRAWN BY 製圖		Ray	DATE 日期	2022-03-29	REV. 版本	A0	
CHECKED BY 審核		Allen	DATE 日期	2022-03-29			